

- KEY**
- EXISTING BUILDINGS
  - EXISTING KERB LINE
- HARDWORKS**
- GRANITE KERB 300MM WIDE KERBS, INCLUDING SPECIALS AT ALL CORNERS, RAMP AND DROPPED KERBS
  - GRANITE PAVING FLAGS WITH MIN 3 ROWS OF GRANITE SETT PAVING ALONG BUILDING LINE
  - DECORATIVE STONE PAVING DETAIL
  - DECORATIVE STONE PAVING BAND
  - TACTILE PAVING FOR CONTROLLED AND UNCONTROLLED PEDESTRIAN CROSSINGS
  - NEW ASPHALT SURFACE TO EXISTING ROAD
  - GRANITE SETT PAVING TO CENTRE ISLAND, MIN 3 ROWS
  - STEEL EDGE WAVE UP AND DOWN SUPPORTED BY EDGING, MAX HEIGHT 500MM
  - 1800MM HIGH RAILING - MS GAL PPC COLOUR:BLACK

- STREET FURNITURE**
- BESPOKE BANGOR SEAT - (SMALL, MEDIUM & LARGE)
  - FEATURE SAIL - FEATURE SAIL BANNER COLUMN - 7.8M HIGH
  - TELESCOPIC / STATIC BOLLARDS
  - 2 no STAINLESS STEEL CYCLE STANDS
  - DECORATIVE STAINLESS STEEL PEDESTRIAN GUARDS RAILING
- STREET LIGHTING**
- NEW DOUBLE STREET LIGHTING COLUMN
  - NEW SINGLE STREET LIGHTING COLUMN
- SOFTWORKS**
- EXISTING TREE RETAINED
  - EXISTING TREE REMOVED
  - NEW SEMI MATURE TREES PROPOSED TREE PLANTING - *Carpinus betulus* 'Fastigiata', 25-30mm GIRTH, 4x tr, WELL BALANCE CROWN, 2.2m CLEAR STEM, 4.5-5.0m HIGH, 2.5-3.0m SPREAD, RB
  - MATURE INSTANT HEDGE PLANTING - *ELAEAGNUS* x *EBBINGEI*: 1.6M-1.8M HIGH, CG
  - WILDFLOWER SEEDING ground to wave up and down supported by corten steel edging, max height 500mm
  - PROPOSED SHRUB PLANTING AREA
- General Notes**
- 500mm wide reinstatement strip along all kerbs
  - Overhead cables to be underground within the Scheme area of - Abbey Street, Dufferin Avenue, Central Avenue, Kings Street
  - All Kerbs to be 300x250x900mm Granite
  - Tactile Paving to all Road Crossings
  - Bus Kerbs to all Bus Stops
  - Dropped Kerb to all pedestrian crossings at road level
- Drainage**
- Underground all downpipes, drainage to connect into existing sewer

Section AA - Proposed boundary treatment with Abbey Street & Translink Bus Station @ scale 1:40

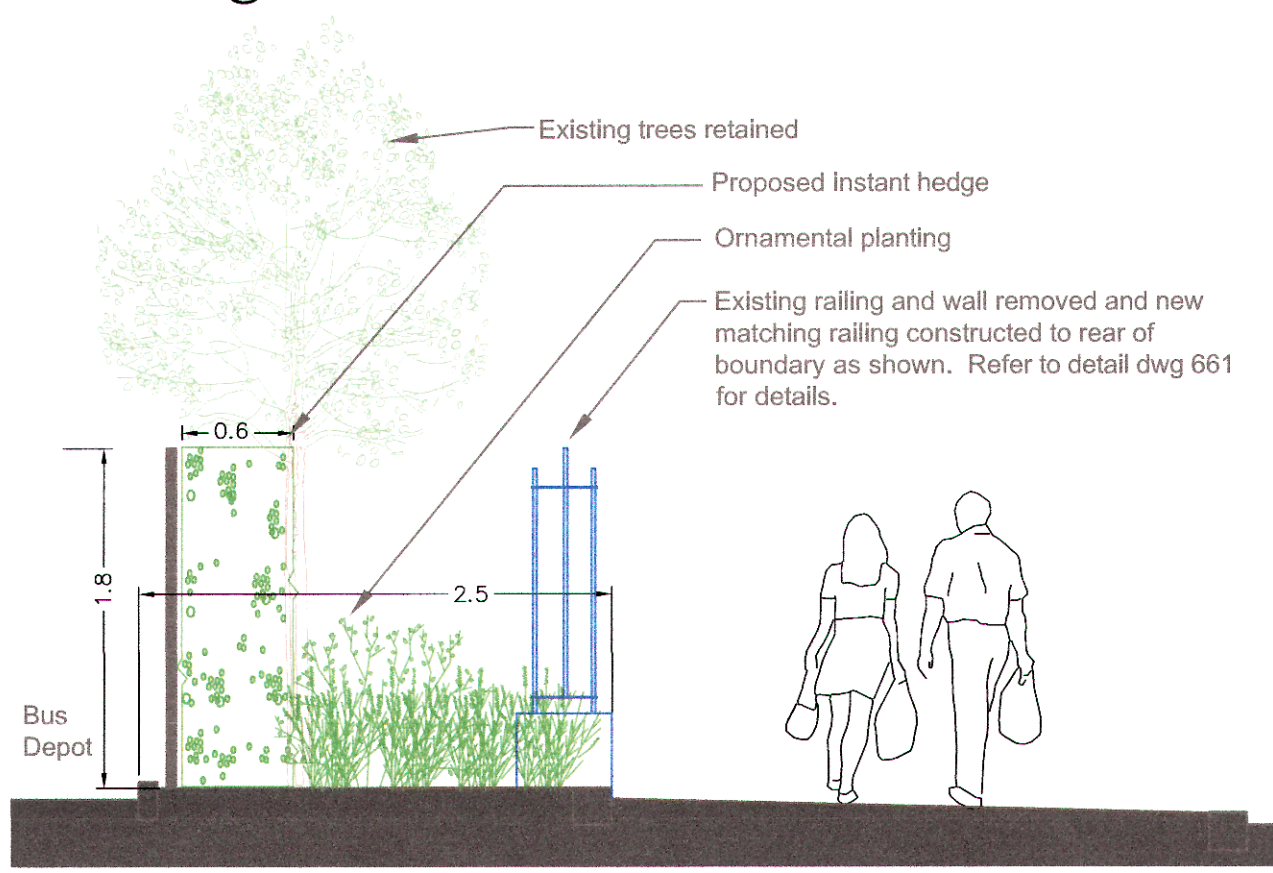

Section AA - Proposed boundary treatment with Abbey Street Car park @ scale 1:40

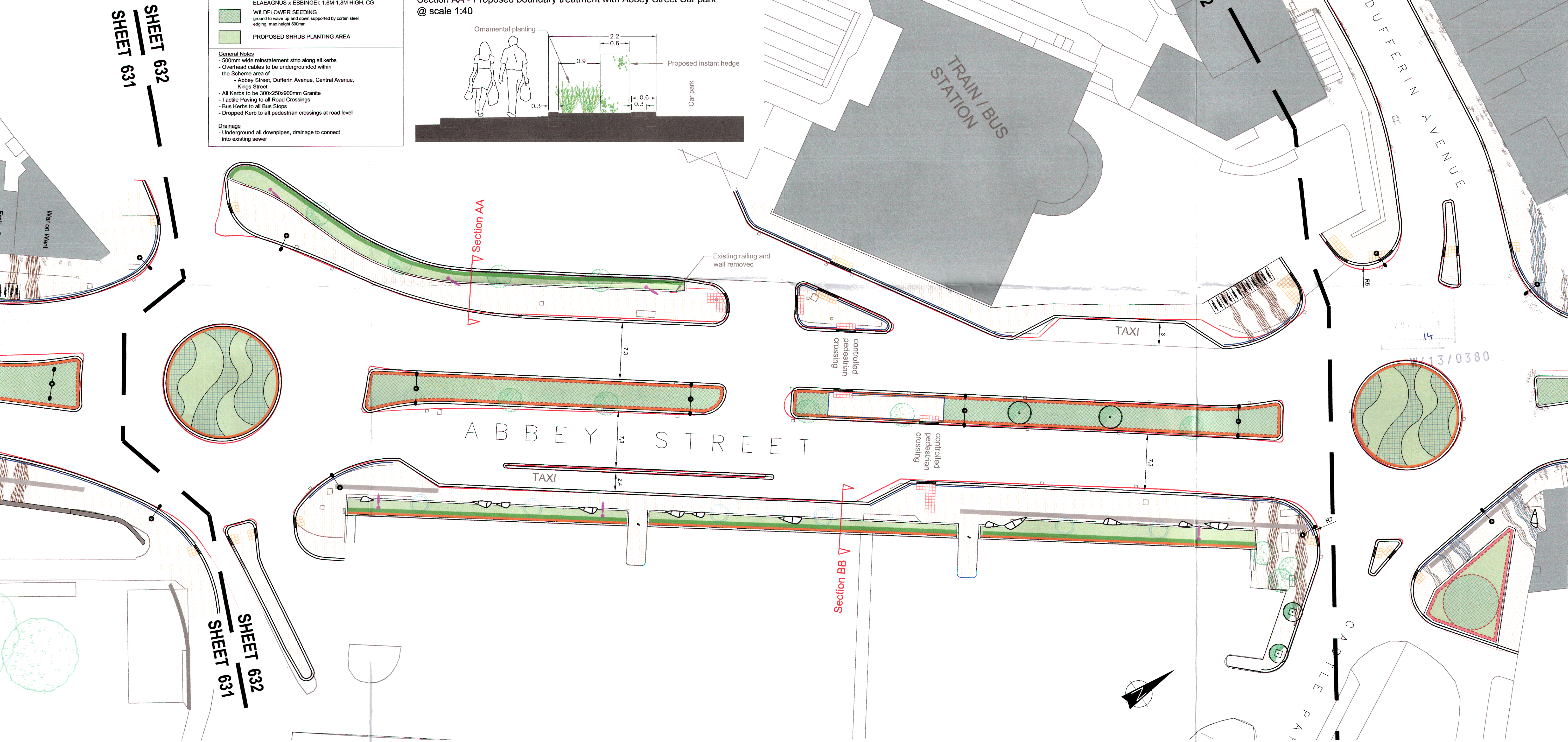
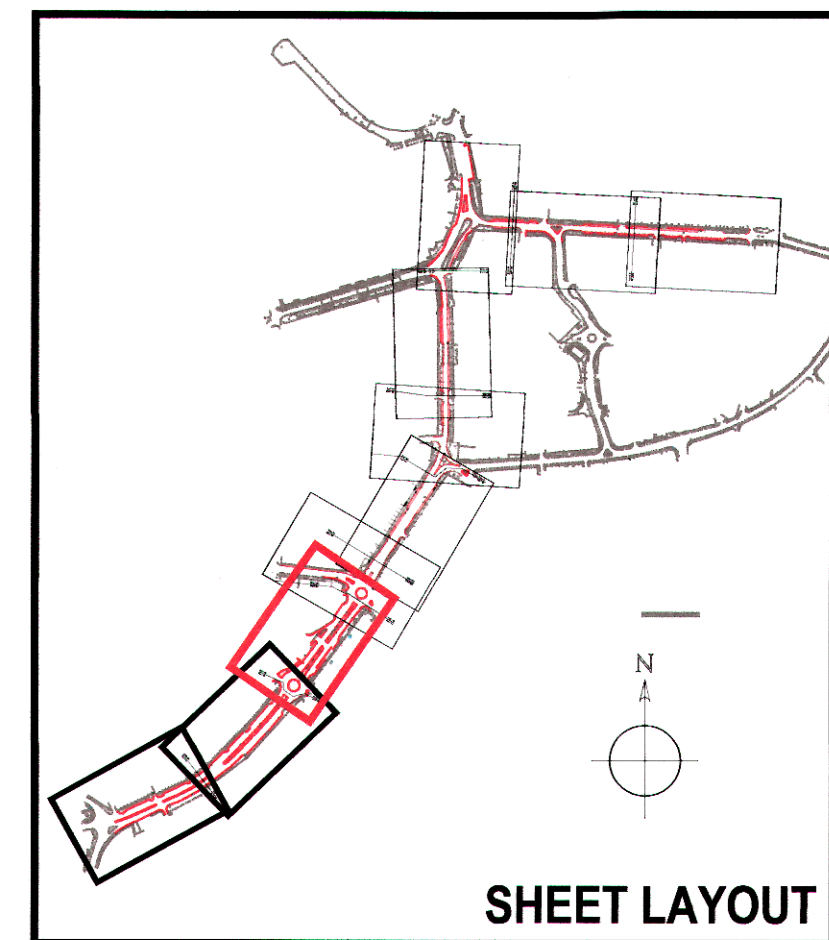
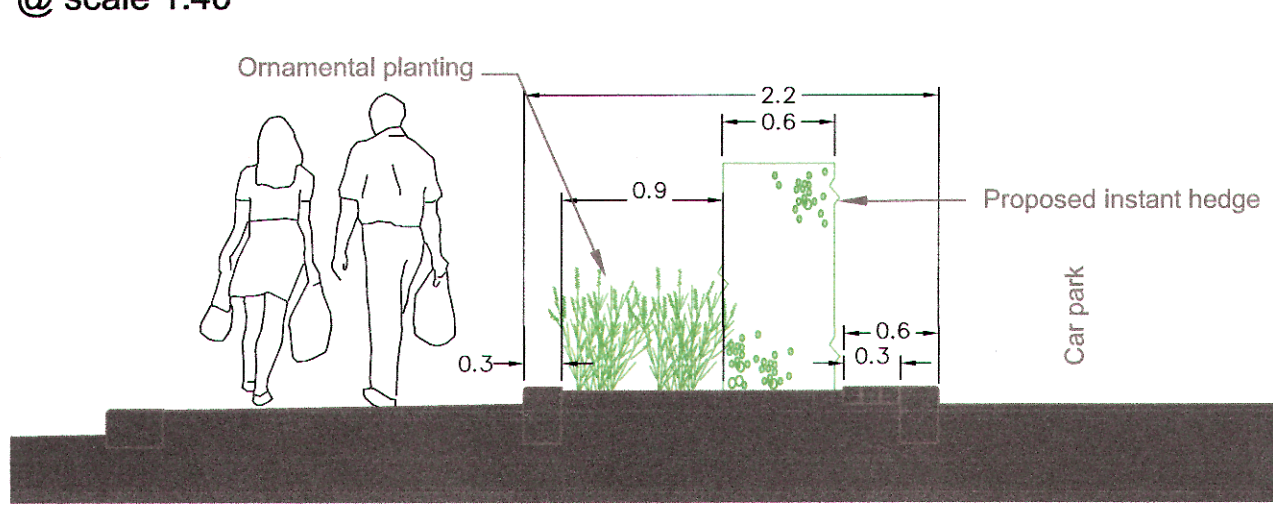

Proj. No.: 10000015 - BAN.P1  
 File Name: C:\PROJECTS\BAN\_GOR & KINGSWOOD PUBLIC REALM - BAN\_GOR.P1 - PROPOSED LAYOUTS

Revision	Details	By	Date	Check	Suff.

NOTES

In addition to the hazard/risks normally associated with the types of work detailed on this drawing take note of above. It is assumed that all works on this drawing will be carried out by a competent contractor working, where appropriate, to an appropriate method statement.

SAFETY, HEALTH AND ENVIRONMENTAL INFORMATION BOX

Purpose of Issue	Client
PLANNING	North Down Borough Council

Project Title	Drawing Title
BANGOR PUBLIC REALM	PROPOSED LAYOUT
	ABBAY STREET
	SHEET 3 of 3

Designed	Drawn	Checked	Approved	Date
NC	NC	PM	CA	JULY 2013

URS Infrastructure & Environment UK Limited  
 Beechill House  
 Beechill Road, Belfast  
 BT8 7RP  
 T: +44 (0)28 9070 5111  
 F: +44 (0)28 9070 5851  
 www.ursglobal.com

Scale	Drawing Number	Rev
@ A1 1:250	47064572 - BAN - 632	P0