

**DISCLAIMER:**  
 TODD ARCHITECTS CONFIRM THAT RECIPIENTS CAN ONLY RELY ON APPROVED CONTROLLED DOCUMENT FORMATS IN CONSTRUCTION PROJECTS. CONTROLLED DOCUMENT FORMATS INCLUDE ORIGINAL HARD COPY DRAWINGS ISSUED BY TODD ARCHITECTS, OR UNPRINTED PDF IMAGES OF DRAWINGS RECEIVED FROM TODD ARCHITECTS. TODD ARCHITECTS CANNOT ENSURE THE ACCURACY OF DRAWINGS USED IN AN UNCONTROLLED DOCUMENT FORMAT WHICH MAY BE ALTERED OR MISINTERPRETED AS A RESULT OF HUMAN ERROR ON THE PART OF THE RECIPIENT, OR AS A RESULT OF THE INCOMPATIBILITY OF COMPUTER SYSTEMS WHEN OPENING OR PRINTING COMPUTER AIDED DRAWINGS. UNCONTROLLED DOCUMENT FORMATS INCLUDE COMPUTER AIDED DESIGN FILES, PRINTS WHICH HAVE BEEN CREATED BY THE RECIPIENT FROM NON-CONTROLLED FILE FORMATS, PHOTOCOPIES OF ORIGINAL HARD COPY DRAWINGS FROM TODD ARCHITECTS, DRAFT DRAWINGS SUPPLIED BY TODD ARCHITECTS FOR INFORMATION PURPOSES ONLY. TODD ARCHITECTS ACCEPT NO RESPONSIBILITY FOR ANY LOSS OR DAMAGE ARISING AS A RESULT OF RELIANCE BY THE RECIPIENT OR ANY THIRD PARTY ON UNCONTROLLED DOCUMENT FORMATS. RELIANCE UPON WHICH WILL BE ENTIRELY AT THE RISK OF THE RECIPIENT.  
 CONTRACTORS ARE RESPONSIBLE FOR THE VERIFICATION OF ALL DIMENSIONS ON SITE AND THE ARCHITECT IS TO BE INFORMED OF ANY DISCREPANCY. USE FIGURED DIMENSIONS ONLY.

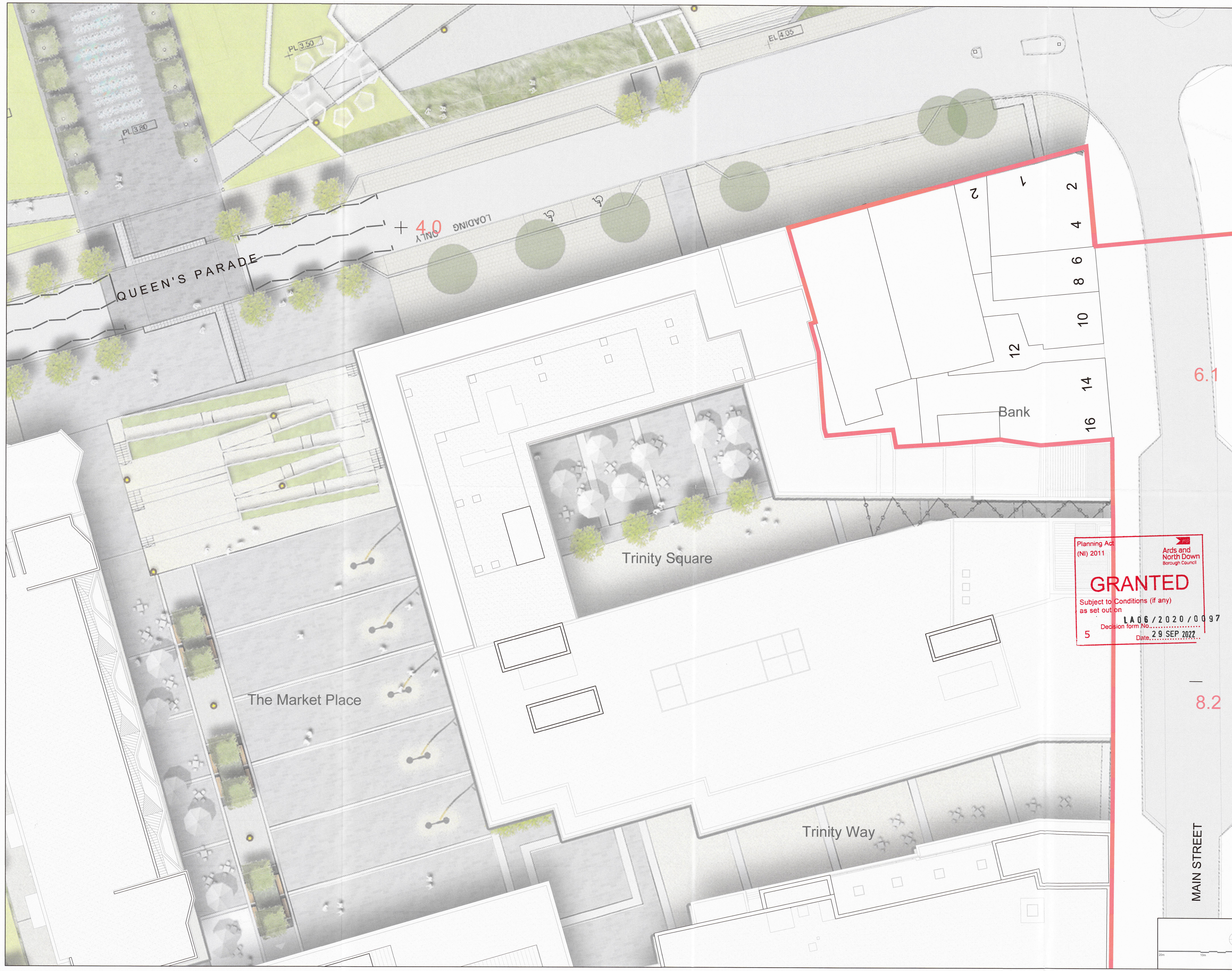

Planning Act (NI) 2011  
**GRANTED**  
 Subject to Conditions (if any) as set out on  
 Decision form No. LA06/2020/0097  
 5 Date: 29 SEP 2022

Ards and North Down Borough Council  
 28 JAN 2020

Drawing 41  
 W.D.

02 23.01.20	Issued for Planning Approval	AC	NM
01 02.12.19	Client Issue	AC	NM
Rev. no.	Date	Amendment	Drawn by / Checked by
Client: Bangor Marine Ltd			
Project Name: Queen's Parade, Bangor			
Drawing Title: Proposed Block 05, 06 & 09 -Hotel, Retail / Office. [Level 6- Roof]			

TODD ARCHITECTS  
 2ND FLOOR TRITON HOUSE  
 6 QUEENS ROAD  
 BELFAST BT3 9DT  
 T +44 (0) 28 9024 5587  
 E INFO@TODDARCH.CO.UK

**TODD**

Date: 02.12.2019	Drawn by: AC	Checked by: NM	Scale: 1:200	Page: A1
Project No: 17017	Status: PLANNING	Sheet No: 002		
Drawing number: QPB-TODD-05-06-GA-A-200-007				

