

DISCLAIMER:
 TODD ARCHITECTS CONFIRM THAT RECIPIENTS CAN ONLY RELY ON APPROVED CONTROLLED DOCUMENT FORMATS IN CONSTRUCTION PROJECTS. CONTROLLED DOCUMENT FORMATS INCLUDE ORIGINAL HARD COPY DRAWINGS ISSUED BY TODD ARCHITECTS, OR UNPRINTED PDF FILES OF DRAWINGS RECEIVED FROM TODD ARCHITECTS. TODD ARCHITECTS CANNOT ENSURE THE ACCURACY OF DRAWINGS USED IN AN UNCONTROLLED DOCUMENT FORMAT WHICH MAY BE ALTERED OR MISINTERPRETED AS A RESULT OF HUMAN ERROR OR THE PART OF THE RECIPIENT, OR AS A RESULT OF THE INCOMPATIBILITY OF COMPUTER SYSTEMS WHEN OPENING OR PRINTING COMPUTER AIDED DRAWINGS. UNCONTROLLED DOCUMENT FORMATS INCLUDE COMPUTER AIDED DESIGN FILES, PRINTS WHICH HAVE BEEN CREATED BY THE RECIPIENT FROM NON-CONTROLLED FILE FORMATS, PHOTOCOPIES OF ORIGINAL HARD COPY DRAWINGS FROM TODD ARCHITECTS, DRAFT DRAWINGS, UNCONTROLLED DOCUMENT FORMATS INCLUDE COMPUTER AIDED DESIGN FILES, PRINTS WHICH HAVE BEEN CREATED BY THE RECIPIENT FROM NON-CONTROLLED FILE FORMATS, PHOTOCOPIES OF ORIGINAL HARD COPY DRAWINGS FROM TODD ARCHITECTS. TODD ARCHITECTS ACCEPT NO RESPONSIBILITY FOR ANY LOSS OR DAMAGE ARISING AS A RESULT OF RELIANCE BY THE RECIPIENT OR ANY THIRD PARTY ON UNCONTROLLED DOCUMENT FORMATS. RELIANCE UPON WHICH WILL BE ENTIRELY AT THE RISK OF THE RECIPIENT.
 CONTRACTORS ARE RESPONSIBLE FOR THE VERIFICATION OF ALL DIMENSIONS ON SITE AND THE ARCHITECT IS TO BE INFORMED OF ANY DISCREPANCY. USE FIGURED DIMENSIONS ONLY.

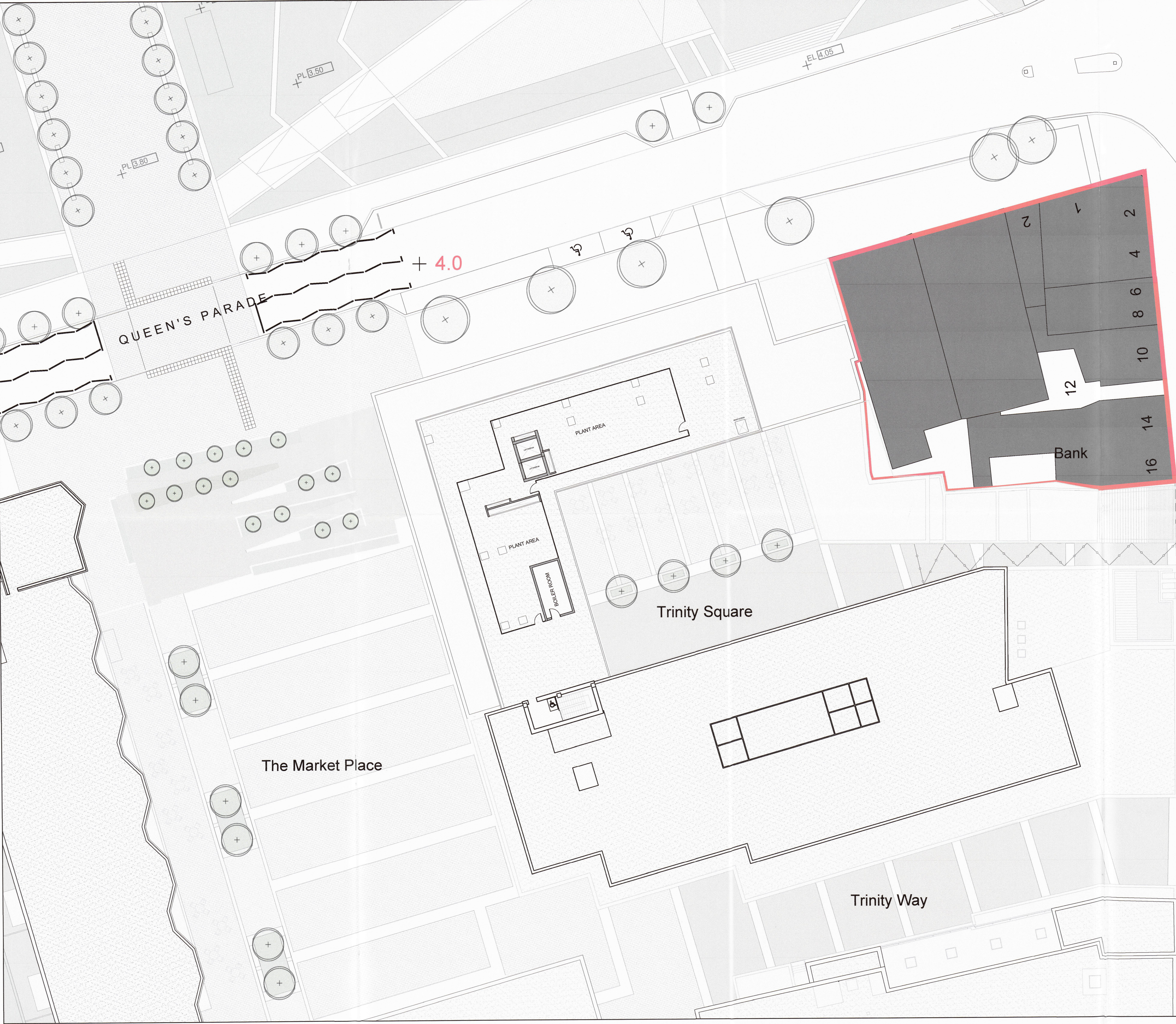

Planning Act (NI) 2011
Ards and North Down Borough Council
GRANTED
 Subject to Conditions (if any) as set out on
 Decision Ref: 19/06/2020/0097
 Date: 29 SEP 2022

Drawing Number: 39 B
 Ards and North Down Borough Council

22 DEC 2020
 19/06/2020/0097

04	18.12.20	Red Line amended	AC	NM
03	06.07.20	Blocks 1, 2, 5&6 amended for submission to Planning Authority	AC	NM
02	23.01.20	Issued for Planning Approval	AC	NM
01	02.12.19	Client Issue	AC	NM

Rev no	Date	Amendment	Drawn by	Chkd by

Client: **Bangor Marine Ltd**

Project Name: **Queen's Parade, Bangor**

Drawing Title: **Proposed Block 05, 06 & 09 -Hotel, Retail / Office. [Level 05]**

TODD ARCHITECTS
 2ND FLOOR FITZPATRICK HOUSE
 6 GREENS ROAD
 BELFAST, BT3 3BQ
 T: +44 (0) 28 9024 5587
 E: INFO@TODDARCH.CO.UK

Date: 02.12.2019
 Drawn by: AC
 Chd by: NM
 Scale: 1:200
 Page: A1

Project Ref: 17017
 Status: PLANNING
 Drawing Number: 004

QP-B-TODD-05-05-GA-A-200-006

